

Banner Stand Mounting

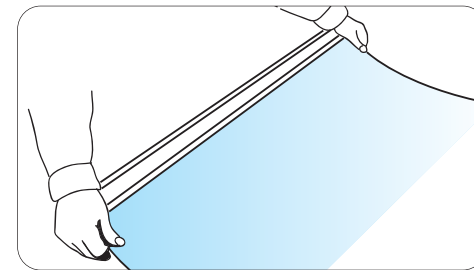
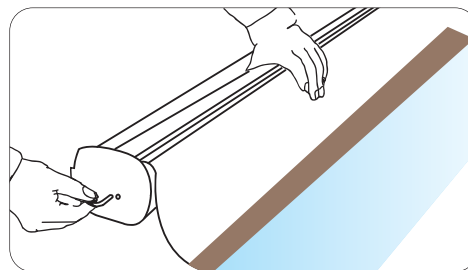

Mounting a banner to all our models of retractable banner stands is very much the same. The top is fitted to the rail of your choice, and the bottom is attached to the white PVC "leader" already fitted inside the stand by your preferred method of the choices available. Illustrated descriptions of rail and leader mounting methods appear in this file.

Once the top (rail) is fitted, and the bottom (banner-to-leader) is attached, activate the spring tension in the roller by removing the locking key while holding on to the attached graphic banner, slowly let the banner roll into the housing, making sure that it is centralised as it rolls in. Save the key in the storage location provided, either in the bag or underneath the stand.

All you need to know in addition to this, is what size to print the visible area of your banner, and what size to cut it to, allowing space for attaching the rail at top, and space for attaching the leader at bottom. These dimensions are given in our "Graphic Guides", downloadable from the Customer Support Area of our website, or available by email for those who are unable to download.

Our non-retractable **EasyBanner®** uses rails at both top and bottom (see rail-fitting page), so print your visual area and trim to include only the extra length at both top and bottom required for your choice of rail.

If any further advice is needed, please contact "easy@easystands.com" with your request, and we will always endeavour to provide whatever assistance is needed.

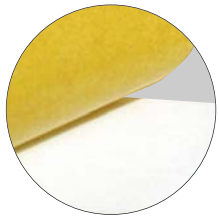

Stick-on

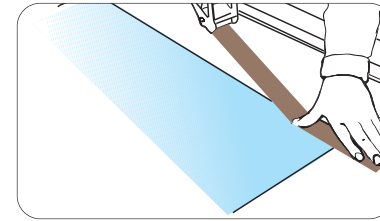
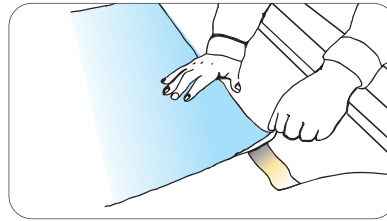

Align the back of the banner with the pre-applied adhesive strip on the front of the white leader, then remove the release liner from the adhesive and stick the banner to the leader accurately. ALSO apply single-sided adhesive tape of your preferred type over the end of the front of the banner onto the leader, to prevent an exposed edge catching.

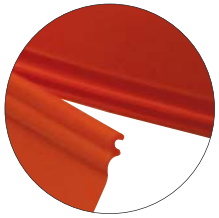

Zip

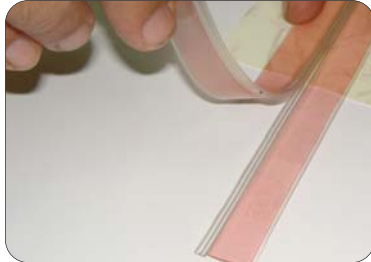

Separate the two parts which are identical

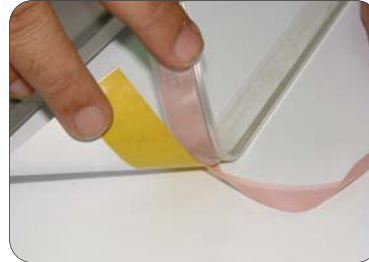

Apply one part to the back of the leader along the top edge with the thickest part of the zip overhanging the edge of the leader



Apply to the bottom front edge of the banner with the thickest part of the zip overhanging the edge of the leader

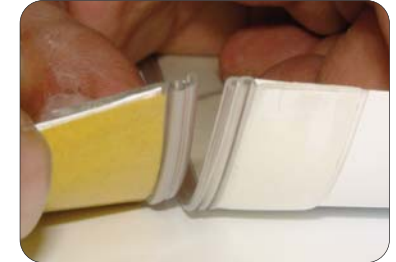

For an effective fitting the zip should appear as above

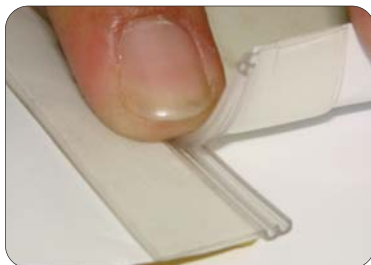

Align the grooves and firmly press together, or fix a few inches only at one side then slide the two together

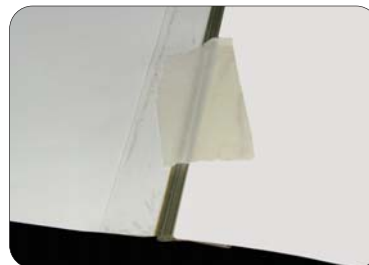

To prevent sliding in use, attach a small piece of masking tape somewhere along the join.

EasyGrip™

Whichever style you prefer

Banner mounting to Leader.

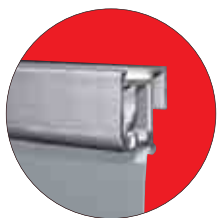

Snap-on
(all models standard)

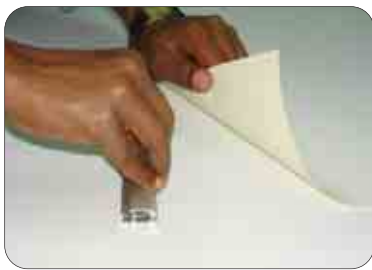

*No tool needed
Place the graphic face up*

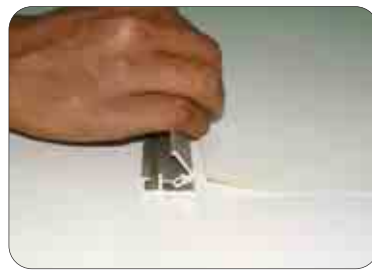

Un-snap the rail



Place the graphic in the slot



Snap shut

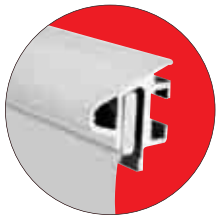

Screw-on
(all models option)



Screwdriver needed



*Loosen screws and remove
pressure bar from rail, and fit it
to the back of the top of the
banner with pre-fitted adhesive*



*flush along the top edge of
the back of the Banner*



*Place the pressure bar fully into
the rail and tighten screws*

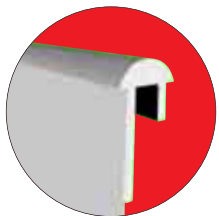

Stick-on
(some models option)



*No tool needed
Place the graphic face up*



*Register the graphic with the
top edge of the rail
Remove the release liner slowly*



*Firmly press the graphic
to the rail*

EasyRail™
Whichever style you prefer